

## Ethernet base controller – replaces CPU for PC-based Control!

The H2-EBC and H2-EBC-F Ethernet Base Controller modules provide a low-cost, high-performance Ethernet link between your PC-based control system and **Direct**LOGIC DL205 I/O. The H2-EBC module supports industry standard 10BaseT Ethernet communications, and the H2-EBC-F module supports 10BaseFL (fiber optic) Ethernet standards. Both modules offer 10Mbps transfer rates between your PC application and your DL205 I/O base. The EBC modules are compatible with IP and IPX protocols for flexible PC communications. Four addressing schemes make it easy to identify the module on the network using the method that works best for you.

- Save money on your **Direct**LOGIC I/O system compared with competitive I/O
- Virtually unlimited number of I/O points
- Deterministic I/O updates on dedicated networks
- Use off-the-shelf networking components to connect to your existing network
- Fast I/O updates - < 1ms per base
- On board serial port for Operator Panel, etc.

## Easy to use, reliable and fast

The H2-EBC(-F) module plugs into the CPU slot of any DL205 I/O Base. The 10BaseT or 10BaseFL port can be networked using commercially available cabling, hubs, and repeaters. One H2-EBC(-F) is required for each DL205 I/O base being networked. The H2-EBC(-F) module supports all DL205 discrete and analog I/O modules. See "Choose your I/O Modules" in the DL205 section. Specialty and intelligent modules are not supported by the H2-EBC(-F).

Specifications	H2-EBC	H2-EBC-F
<b>Communications</b>	10BaseT Ethernet	10BaseFL Ethernet
<b>Data Transfer Rate</b>	10Mbps	10Mbps
<b>Link Distance</b>	100 meters (328 ft)	2,000 meters (6,560 ft)
<b>Ethernet Port</b>	RJ45	ST-style fiber optic
<b>Ethernet Protocols</b>	TCP/IP, IPX	TCP/IP, IPX
<b>Power Consumption</b>	530mA	670mA
<b>Manufacturer</b>	Host Engineering	Host Engineering

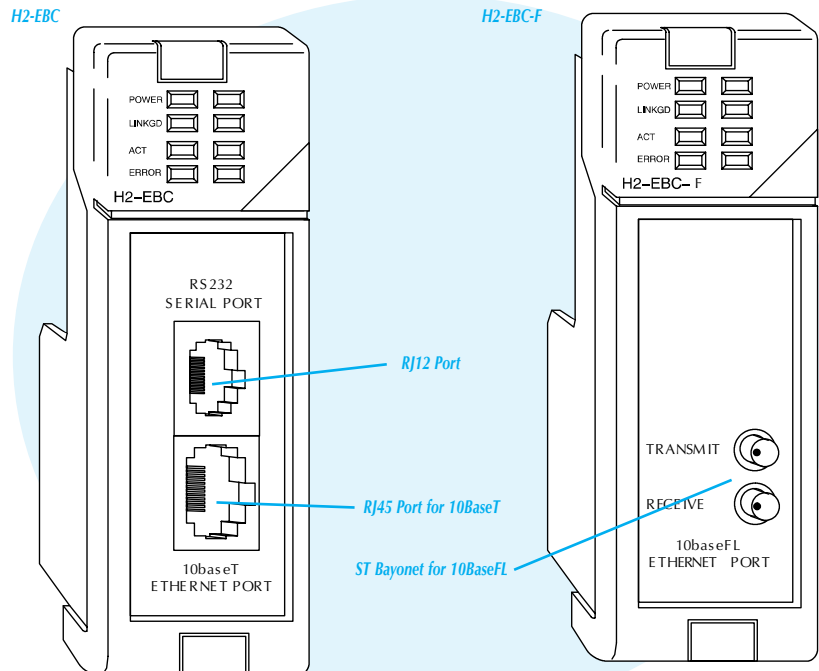

Ask for our D2-INST-M installation and I/O Manual for complete information about DL205 I/O modules, power budgeting, and installation and wiring. This manual does not cover CPU-slot controllers.

## Off-the-shelf solutions

You can purchase PC-based Control software which is ready to use with the H2-EBC(-F) module. PC-based Control packages are equipped with compatible I/O device drivers, program development tools, and run-time environments. See the PC-based Control section for a single-source integrated PC-based Control solution that ships with everything you need to make your PC into an industrial controller. Connect an operator interface panel to the serial port, if desired.

*The chart to the right identifies vendors that have PC-based Control products ready to control DirectLOGIC I/O, or have products to be released in the immediate future.*

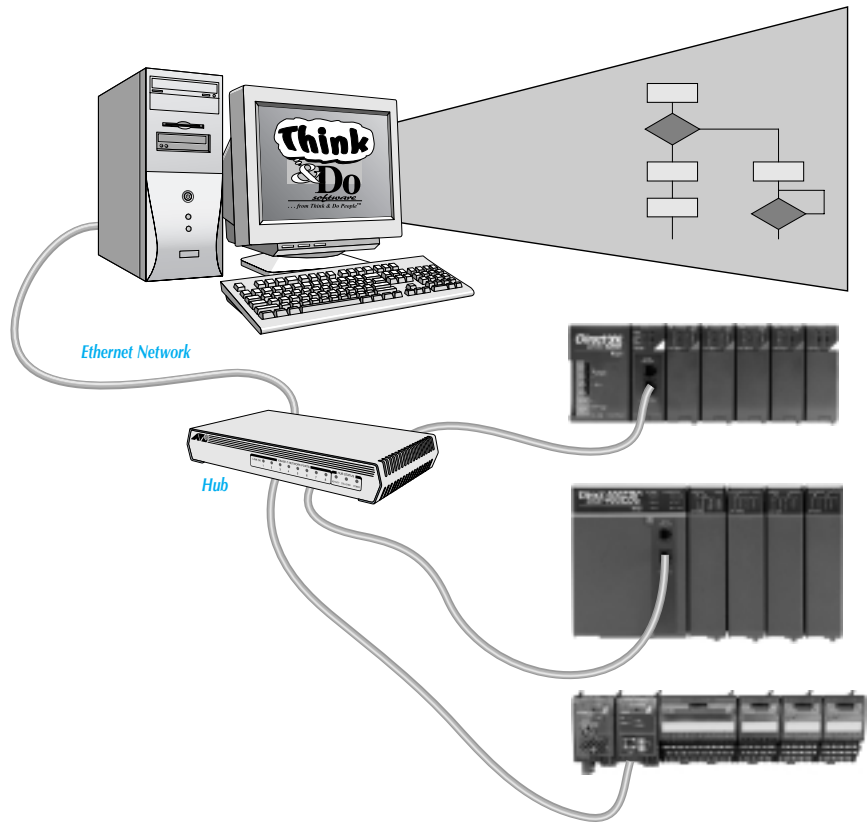

## Software developers

For programmers developing custom drivers for our I/O, we offer a free Ethernet Software Development Kit (SDK). The SDK provides a simplified API for interfacing with the H2-EBC(-F). The software interface libraries are provided for WIN32, WIN16, and DOS operating systems. The source code is available to developers under a non-disclosure agreement. Visit the technical support link at our Web site for more information.



*We provide the tools you need to write communication drivers for our high-performance DL205 I/O.*

Vendor	Product	Web Address
<b>KW Software</b>	MULTIPROG	www.kw-softwareusa.com
<b>eMation</b>	WizPLC, Wizcon, WIZDCS, Unity	www.emation.com
<b>Steeplechase Software</b>	Visual Logic Controller	www.steeplechase.com
<b>Think &amp; Do</b>	<b>Think &amp; Do</b>	<b>www.thinkndo.com</b>
<b>Wonderware</b>	InControl	www.wonderware.com

Check our Web site for the latest list of vendors.